

# WILLOWBROOK WILDLIFE CENTER MASTERPLAN PHASE II UPDATE APRIL 13, 2021

# LOCATION MAP

- Willowbrook Wildlife Center  
525 South Park Boulevard  
Glen Ellyn, IL 60137

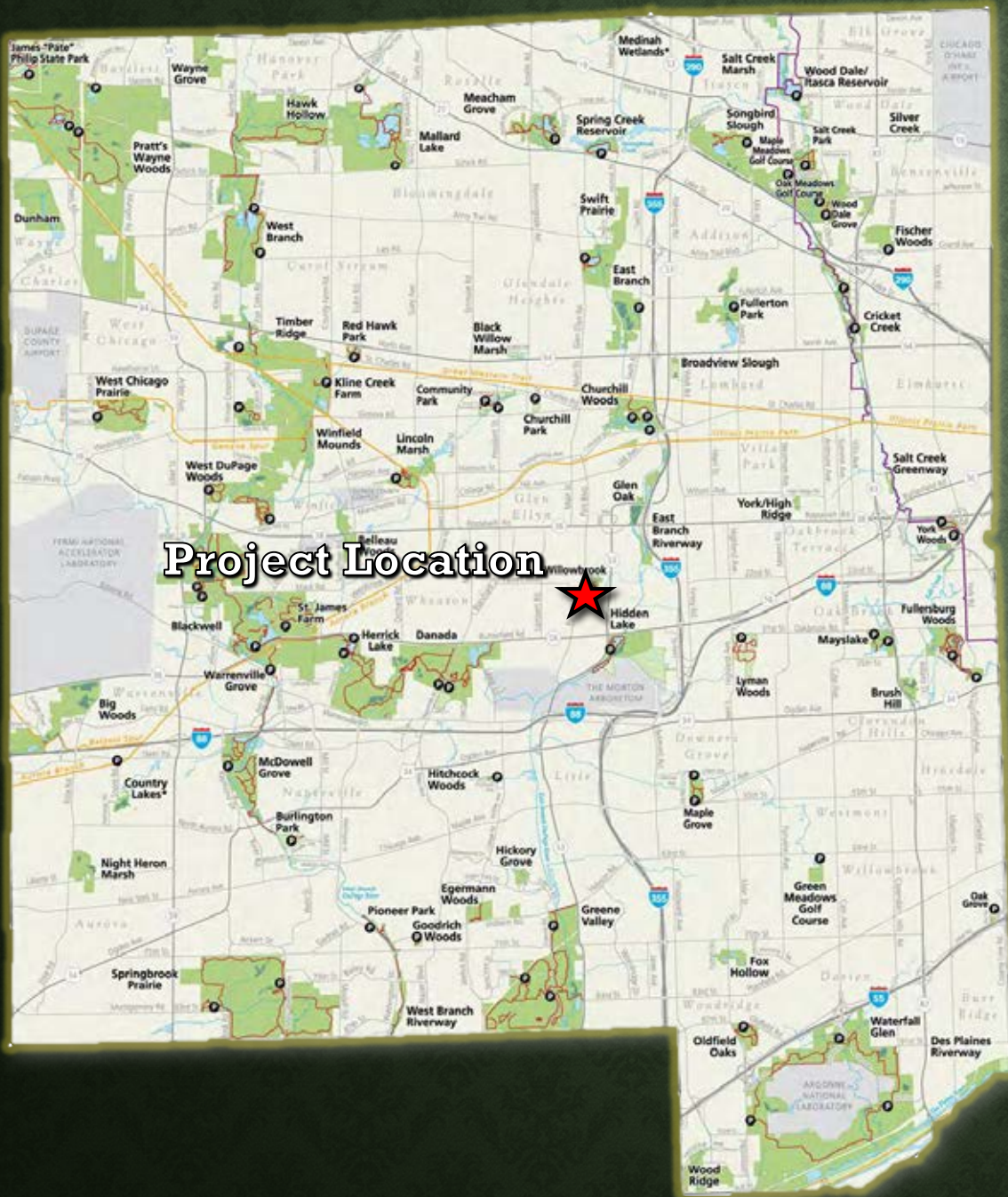

# DEVELOPMENT TIMELINE

- 2011 – Master plan completed and approved
- 2015 – Master plan phase I completed
- 2020 – New vision identified for Willowbrook (Driven by mission and changes to the science of wildlife rehabilitation)
- 2021 – Phase II master plan program developed.

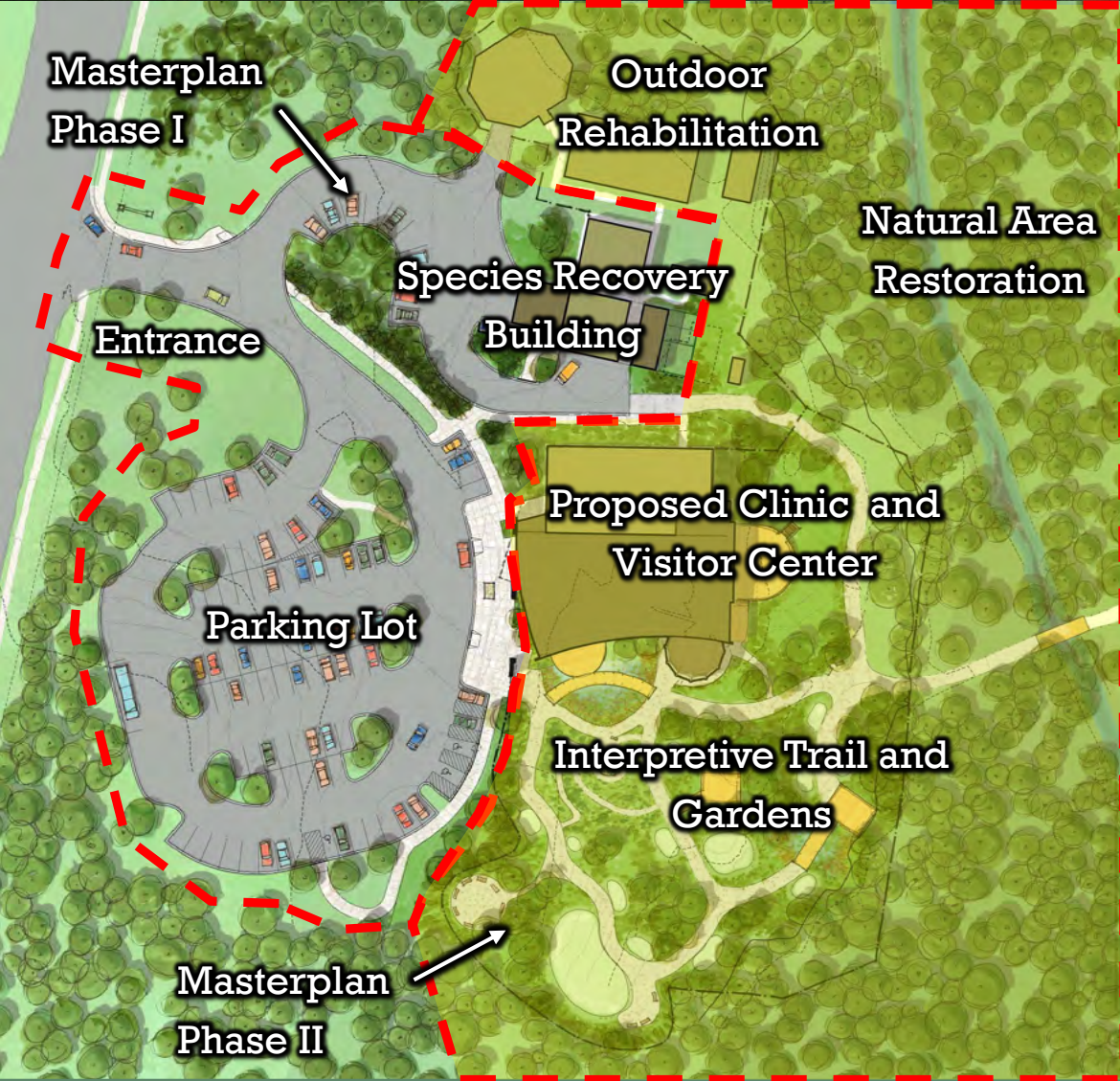

## WWC MASTERPLAN DEVELOPMENT PHASE I AND PHASE II



# CONTEXT

- Previous master plan phase II
- January 2020: All staff workshops to identify vision and values
- Current direction: Focus on rehabilitation, research and well-being of wildlife
- Tighter alignment with the District mission

## WWC MASTERPLAN PHASE II BACKGROUND





Willowbrook Wildlife Center at Willowbrook Forest Preserve in Glen Ellyn is a native wildlife rehabilitation facility that provides care and medical treatment to injured and orphaned wild animals. It also serves as a resource to teach DuPage residents about living in harmony with local wildlife.

## **WWC MASTERPLAN PHASE II WILLOWBROOK PURPOSE**





Willowbrook Wildlife Center is a state of the art wildlife rehabilitation facility that is a national leader in engaging visitors in veterinary science, medical care and wildlife rehabilitation while championing healthy interconnected ecosystems to foster safe, healthy, and sustainable communities for all living things in DuPage County and beyond.

## **WWC MASTERPLAN PHASE II WILLOWBROOK VISION**





### ***Respect***

Willowbrook believes in promoting an inclusive environment where mutual respect for our environment, the wildlife that resides in it and each other is held to a high standard.

### ***Empathy***

While our feelings and experiences will never be comparable to the non-human living beings within our shared environment, we can and should anticipate the needs and challenges of the native wildlife in our care.

### ***Stewardship***

Willowbrook's role in wildlife rehabilitation is a critical part of managing DuPage County natural areas, and is integral to the responsible use and protection of the natural environment through conservation and sustainable practices.

# **WWC MASTERPLAN PHASE II CORE VALUES**





### ***Knowledge***

Willowbrook staff members are constantly striving to gain knowledge to better support the animals we rehabilitate and the environment they are returned back into. It is critical that we not only learn from leaders in the veterinary, rehabilitation, and environmental science fields but that we also share our knowledge with others.

### ***Innovation***

Willowbrook is dedicated to becoming a leader in wildlife medicine and rehabilitation. This transformation will be driven through innovative idea generation and agility in our approach to all areas of medical care, rehabilitation practices, environmental-friendly protocols, and community involvement.

### ***Outreach***

Willowbrook aims to be inclusive in our outreach to audiences of different ages, experiences, and socioeconomic backgrounds and provide a shared experience where all members of the community can feel closer to their environment and native wildlife.

# WWC MASTERPLAN PHASE II CORE VALUES







- 1) To transition away from having a collection of non-releasable animals to focusing on rehabilitation and reintroduction into the wild.
- 2) To improve animal safety and conditions for the rehabilitation and restoration of animal species.
- 3) To improve facility safety and efficiency for staff and volunteers.
- 4) To engage and immerse the public in the wildlife rehabilitation processes and native ecosystems.
- 5) To support propagation of at-risk species that will advance wildlife medicine and rehabilitation.
- 6) To make Willowbrook Wildlife Center more sustainable and energy efficient.

## **WWC MASTERPLAN PHASE II DESIGN PROGRAM GOALS**





- Change in mindset in regard to animal welfare of resident animals
- Advances in wildlife medicine and rehabilitation practices
- Decline in local, national, and international presence

## WWC MASTERPLAN PHASE II REHABILITATION TODAY

# WILLOWBROOK WILDLIFE CENTER PROPOSED SITE DIAGRAM



# MAIN COMPONENTS

- New Clinic and Visitor Center - 32,053 GSF
- Existing Building Conversion – 4,400 GSF
- Outdoor Rehabilitation Areas – 34,249 GSF
- Welcome Plaza
- Outdoor Classroom / Amphitheater
- Interpretive Trail w/ Observation Nodes
- Wildlife Gardens



## WWC MASTERPLAN PHASE II ENLARGED SITE DIAGRAM

## ITEM DESCRIPTION

## COST

Outdoor Rehabilitation Phase I	\$ 3,400,000.00
New Clinic, Indoor Rehabilitation and Visitor Center	\$ 16,500,000.00
Existing Clinic Demolition	\$ 120,000.00
Outdoor Rehabilitation Phase II	\$ 2,260,000.00
Site Development	\$ 1,060,000.00
Species Recovery Building Conversion	\$ 360,000.00

## Total Cost

\$ 23,700,000.00

\*All design, permitting costs, misc. fees, contingencies and construction costs included in the above numbers.

# WWC MASTERPLAN PHASE II PROBABLE ESTIMATE OF COSTS





# WIGHT PROPOSAL TASKS

- 1) Schematic design, alternatives analysis, facility research and updated probable estimates of cost
- 2) Master plan graphic update
- 3) Amending Village of Glen Ellyn's special use permit for Willowbrook Wildlife Center
- 4) Visitor experience workshop and charrette (Discovery of potential visitor interactions and interpretive messaging)

## WWC MASTERPLAN PHASE II SCHEMATIC DESIGN PHASE





# SCHEDULE AND EXPENDITURES

- Spring/Summer 2021 - Complete schematic design and amend special use permit through Village of Glen Ellyn. (\$435,000)
- Summer/Fall 2021 – Negotiate contract for design development services and present to Board for approval. Upon approval complete design development work by winter 2021/2022. (\$250,000)
- Winter 2021/2022 – Negotiate contract for construction/bid documents , permitting and bid assistance for multi-phased work and present to board for approval. Upon approval complete plans for outdoor rehabilitation phase I by spring 2022 and clinic, visitor center, outdoor rehabilitation phase II, SRC building renovation, and site work by winter 2022/2023. (\$635,000)

## WWC MASTERPLAN PHASE II PROPOSED IMPLEMENTATION PLAN





# SCHEDULE AND EXPENDITURES

- **Spring 2022** – Bid outdoor rehabilitation phase I work and present construction contract to Board for approval. Upon approval complete work by summer/fall 2022. (\$3,150,000)
- **Winter 2022/2023** – Bid new clinic and visitor center, outdoor rehabilitation phase II, demolition of old clinic, and renovation of species recovery building work. Negotiate contract for construction administration services and present both contracts to Board for approval. (\$540,000)
- **Spring 2023 - Winter 2025** – Construct improvements as follows: New clinic ,visitor center and demolition of old clinic by summer 2024, outdoor rehabilitation phase II by fall 2024, and SRC building renovation by winter 2025. (\$18,690,000)

## WWC MASTERPLAN PHASE II PROPOSED IMPLEMENTATION PLAN







# KEYNOTES AND MILESTONES

- New clinic and visitor center soft opening summer /fall 2024.
- All work completed by February 1, 2025
- Preserve will be closed to general visitors at times. However, it is anticipated that the Willowbrook Wildlife Center will be able to receive and rehabilitate wildlife at all times.
- Ribbon cutting anticipated spring 2025

## WWC MASTERPLAN PHASE II SCHEDULE SUMMARY



**QUESTIONS?**

